

0002691 02/09/2000 10:34A 1 of 1  
Pamela K. Berglund, Tippecanoe County Recorder

AN AMENDMENT TO THE  
ADOPTED THOROUGHFARE PLAN  
REGARDING THE McCARTY LANE EXTENSION  
CHANGING TO PRIMARY ARTERIAL STATUS SR 26, McCARTY LANE,  
CR 500/475 E AND ADJUSTING THE LOCATION OF CR 350 S

THE COMPREHENSIVE PLAN FOR  
TIPPECANOE COUNTY  
VOLUME 4: THE THOROUGHFARE PLAN  
ADOPTED SEPTEMBER 16, 1981  
MISC. 81 - PAGE 446 /

TIPPECANOE COUNTY AREA PLAN COMMISSION  
20 NORTH THIRD STREET  
LAFAYETTE, INDIANA 47901-1209

KARL RUTHERFORD, PRESIDENT  
JAMES D. HAWLEY, EXECUTIVE DIRECTOR

FEBRUARY 2000

ADOPTED BY THE AREA PLAN COMMISSION OF TIPPECANOE COUNTY AT ITS  
REGULAR MEETING ON JANUARY 19, 2000

## CERTIFICATE

I, James Hawley, Executive Director of the Area Plan Commission of Tippecanoe County, on this 9<sup>th</sup> day of February, 2000 do hereby certify to the Tippecanoe County Recorder that: That the Comprehensive Plan for Tippecanoe County and its various elements were previously adopted and recorded pursuant to statute in the Office of the Tippecanoe County Recorder as Record No. Misc. 81 page 434, on October 23, 1981; and,

Pursuant to IC 36-7-4-508(b) the Area Plan Commission has approved an amendment to the Comprehensive Plan for one of its member governments: Tippecanoe County, Indiana, at a public hearing held January 19, 2000; and ,

All hearings and meeting notices required by IC 36-7-4-507 to amend the Comprehensive Plan were held and complied with; and,

The amendment is known as "an amendment to add the McCarty Lane Extension to the Adopted Thoroughfare Plan. Changing the status of SR 26 E, CR 500/475 E, and McCarty Lane to Primary Arterials and adjusting the location of CR 350 S" and is attached to this certificate; and,

Pursuant to IC 36-7-4-508(b) I did certify this amendment to the Board of Commissioners of Tippecanoe County, Indiana; and,

The attached signed Resolution 2000-07-CM verifies the adoption of this amendment to the Thoroughfare Plan, a part of the Comprehensive Plan, by the legislative body: Tippecanoe County, pursuant to IC 36-7-4-509(a); and,

Pursuant to IC 36-7-4-509(b) I do hereby present these documents to Tippecanoe County Recorder to be kept on file in the office of the County Recorder.

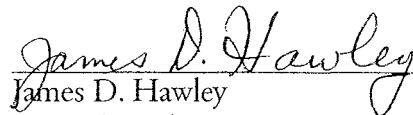
  
James D. Hawley  
Executive Director  
Area Plan Commission of Tippecanoe County

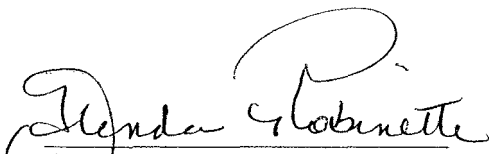
  
Attest  
Glenda Robinette

This document prepared by the Area Plan Commission of Tippecanoe County, Indiana.

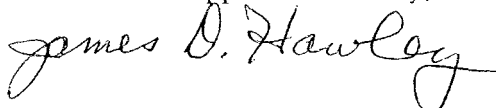

RESOLUTION 2000-07 - CM

RECEIVED  
FEB 09 2000  
THE AREA PLAN COMM.  
OF TIPPECANOE CO.

WHEREAS, the Tippecanoe County Board of Commissioners did hire the American Consulting Engineers, Inc. to study the necessity of and a location for the McCarty Lane Extension from CR 500 E to SR 26 E, and

WHEREAS, the study has been completed with a recommended route chosen, and

WHEREAS, The Board of County Commissioners has requested by Resolution 99-26-cm, that the Area Plan Commission study and recommend an amendment to the Thoroughfare Plan, and

WHEREAS, the recommended route is supported by the Greater Lafayette Area Transportation and Development Study's 2015 Transportation Plan, and

WHEREAS, the McCarty Lane Extension will be shown as a Rural Primary Arterial, and

WHEREAS, certain changes to the Primary Arterial classification for SR 26, McCarty Lane, CR 500/475 E, and adjusting the location of CR 350 S are necessary to update the plan, and

WHEREAS, the Area Plan Commission of Tippecanoe County derives authority to approve amendments to the adopted Comprehensive Plan from Indiana Code Section 36-7-4-511; and

WHEREAS, the Area Plan Commission of Tippecanoe County did hold a public hearing following the proper publication of meeting notices under Indiana Code Section 36-7-4-507, to inform and hear discussion on this amendment to the adopted Thoroughfare Plan; and

WHEREAS, the Area Plan Commission of Tippecanoe County after due consideration unanimously adopted this amendment to the Thoroughfare Plan as described and shown in the attached staff report and maps, finding it to be in accord with its own goals, thus recommending the amendment to the BOARD OF COMMISSIONERS OF THE COUNTY OF TIPPECANOE.

NOW THEREFORE BE IT RESOLVED BY THE BOARD OF COMMISSIONERS OF THE COUNTY OF TIPPECANOE, STATE OF INDIANA, THAT:

The amendment to the adopted Thoroughfare Plan, Volume 4 of the Comprehensive Plan for Tippecanoe County, Indiana, is hereby adopted as described and shown in the attached report and maps.

This Resolution shall be in full force and effect from and after its passage.

ADOPTED AND PASSED BY THE BOARD OF COMMISSIONERS OF THE COUNTY OF TIPPECANOE, STATE OF INDIANA, this 7th day of February, 2000.

BOARD OF COMMISSIONERS  
THE COUNTY OF TIPPECANOE

BY: John Knochel  
John Knochel, Pres.

Ruth E. Shedd  
Ruth Shedd, Vice-Pres.

Kathleen Hudson  
Kathleen Hudson, Member

ATTEST:

Robert Plantenga  
Robert Plantenga, Auditor

## MEMORANDUM

**TO:** Area Plan Commission  
**FROM:** Area Plan Commission Staff  
**SUBJECT:** McCarty Lane Extension: Amendment to the Thoroughfare Plan, Volume 4 of the Comprehensive Plan for Tippecanoe County  
**DATE:** January 14, 2000

---

In September of 1999, the Tippecanoe County Board of Commissioners, by resolution, requested the Area Plan Commission to study and make a recommendation concerning the addition of the McCarty Lane Extension to the Adopted Thoroughfare Plan.

“The Tippecanoe County Board of Commissioners as a member of the Administrative Committee of the Greater Lafayette Area Transportation and Development Study hereby requests the Area Plan Commission of Tippecanoe County to consider, hold hearings, and make recommendations to amend the Adopted Thoroughfare Plan, a part of the Comprehensive Plan for Tippecanoe County, to show a new road extension, McCarty Lane (County Road 100 South), from County Road 500 East eastward to connect with State Route 26 in the vicinity of County Road 675 East, as recommended in the adopted transportation plan for 2015.”

Staff and the transportation advisory committees of the Plan Commission reviewed the documentation for this proposed arterial extension. Both the Technical Transportation Committee and the Administrative Committee unanimously recommended the approval of this addition to the Thoroughfare Plan.

The adopted 2015 Transportation Plan has already documented the need for the McCarty Lane Extension, and the county’s consultant has determined its most appropriate alignment in their report to the Board of Commissioners.

In a further examination of the Thoroughfare Plan network and projected traffic volumes, it was found appropriate to also update other areas of the Thoroughfare Plan east of Lafayette.

Current traffic volumes, projections, and improvements to the arterial network necessitate other adjustments to the Plan in the vicinity. Those include changing to primary arterial status State Road 26 E to the McCarty Lane Extension;

McCarty Lane west of 500 E; CR 500/475 E; and adjusting the location of CR 350 S from SR 38 to US 52.

Proposed "Before" and "After" graphics are attached.

All of these adjustments have also been recommended by the Area Plan Commission transportation advisory committees.

Staff Recommendation

Approval of the proposed Thoroughfare Plan Amendment



# Thoroughfare Plan Rural Area Before Amendment

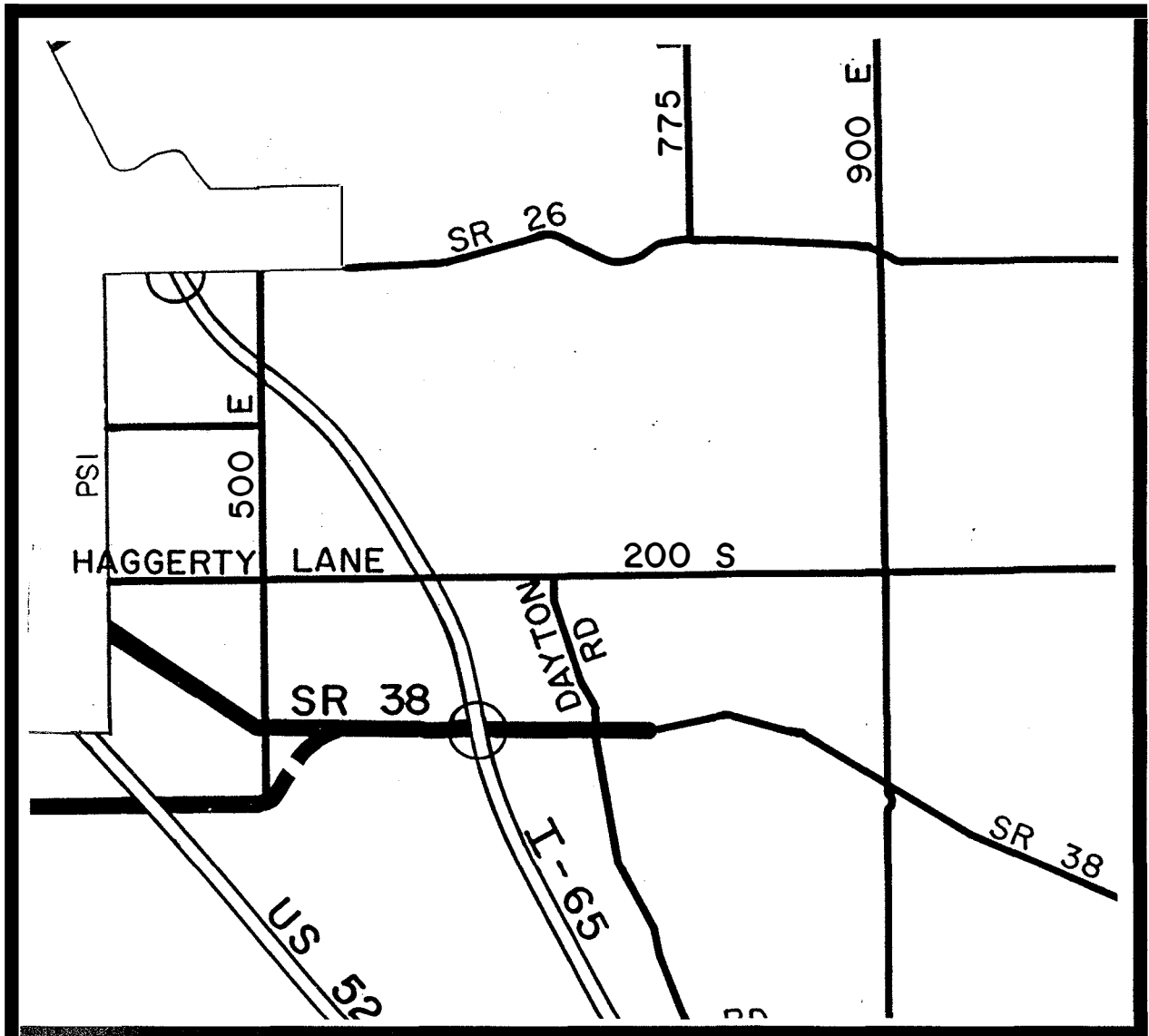

# Thoroughfare Plan Rural Area After Amendment

(McCarty Lane Extension)  
January 2000

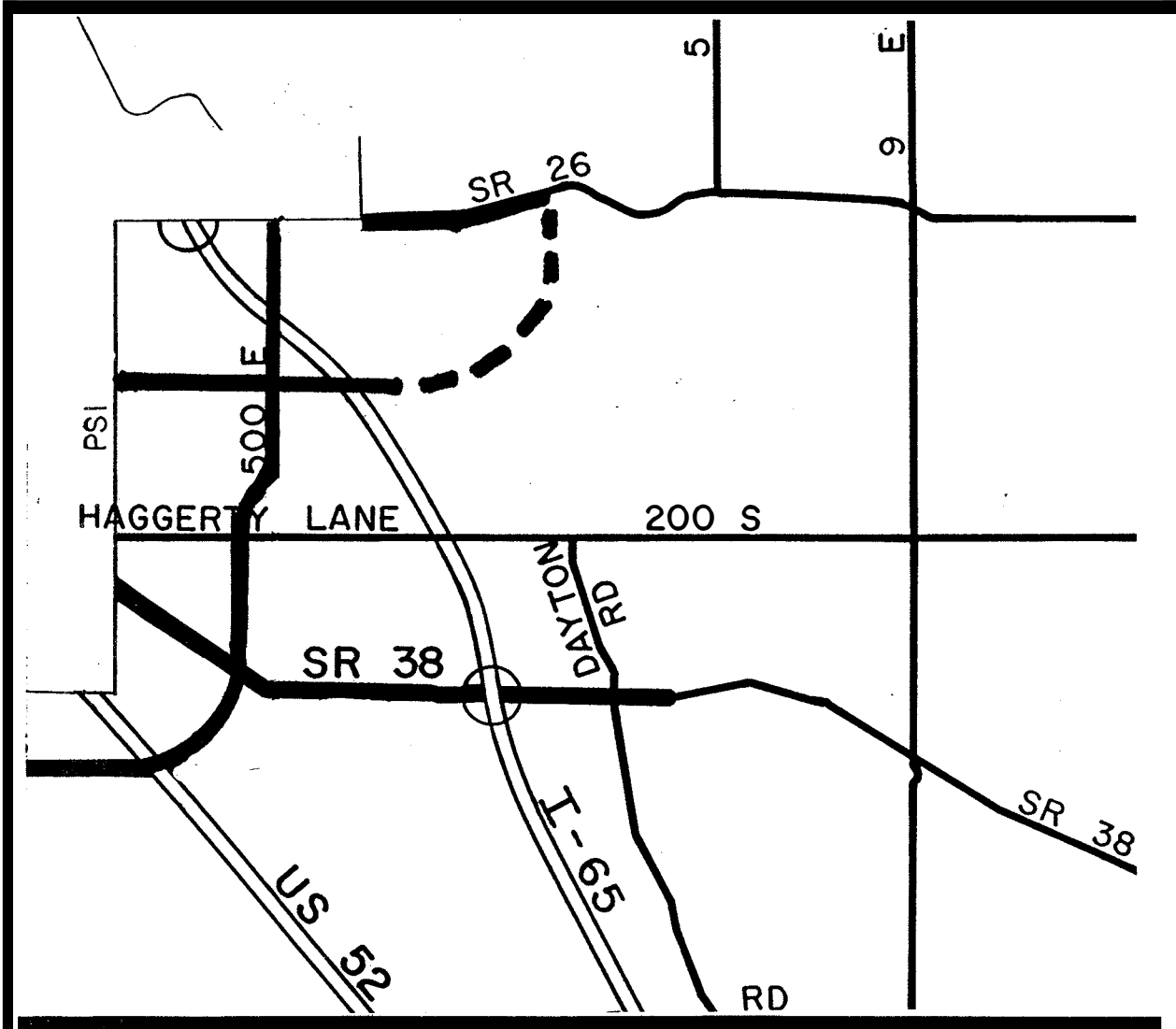



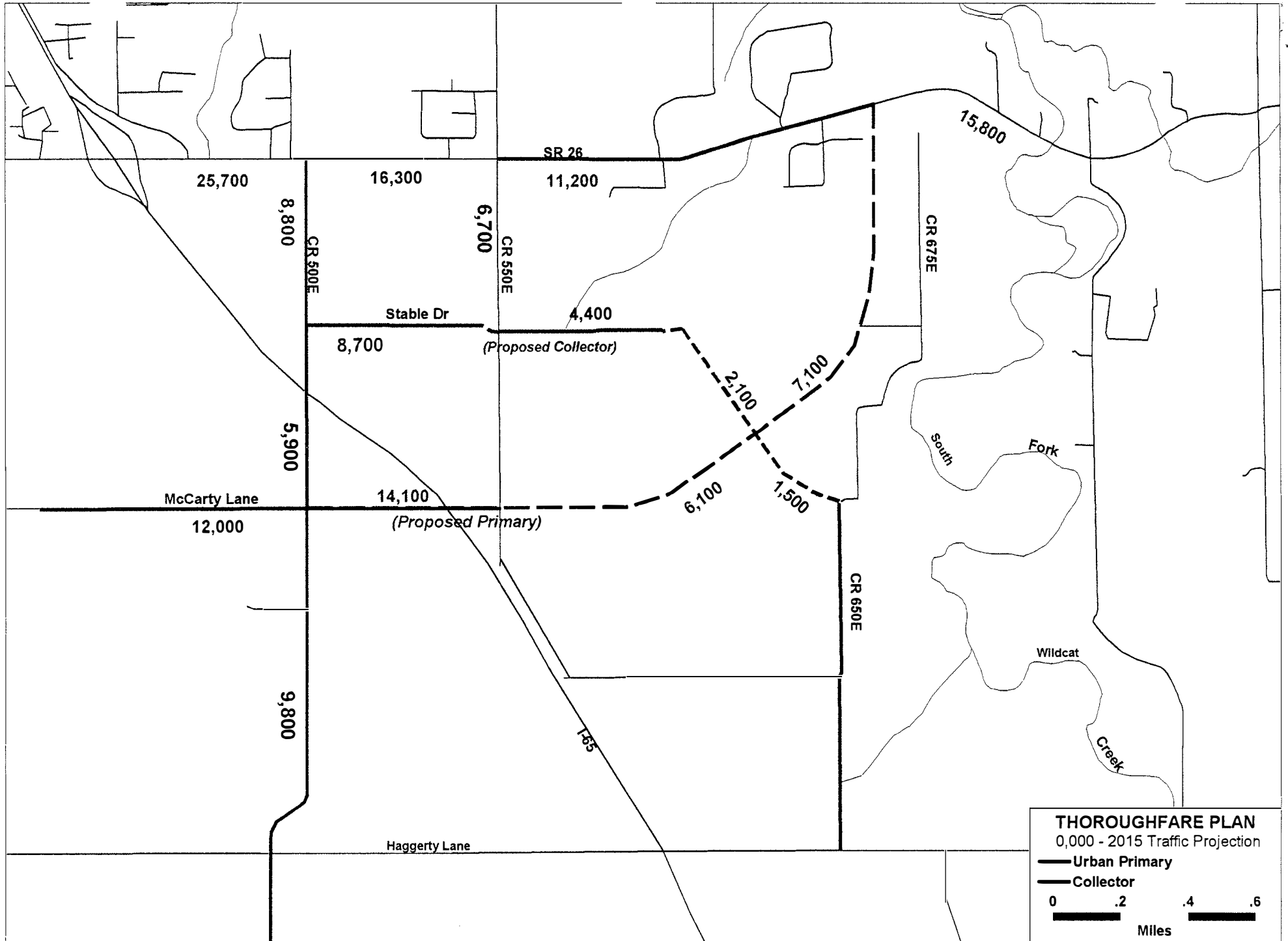



AMENDMENTS TO THE SUBDIVISION ORDINANCE  
NEW COLLECTORS  
July 2001

Amendment Date	New Classification	Road	Location
July 18, 1984	Rural Residential Collector	Eisenhower Road	Between CR 400E & CR 200N
February 17, 1988	Urban Non-residential Collector	Progress Drive	From SR 26 Extended South to Future Subdivision Streets
July 18, 1990	Urban Residential Collector	CR 50E	Beck Lane to CR 350S
February 21, 1996	Non-Residential Collector	Park East Boulevard Extended	SR 26 to SR 38
February 21, 1996	Non-Residential Collector	Connector	Park East Boulevard Extended to Progress Drive
February 21, 1996	Non-Residential Collector	East/West Connector	Creasy Lane to Park East Boulevard Extended
December 16, 1998	Urban Non-Residential Collector	Tapawingo Drive North	SR 26 to SR 43 (State Street to North River Road)
January 19, 2000	Urban Residential Collector	Stable Drive and Future Extension	CR 500E to CR 650E
January 19, 2000	Rural Non-Residential Collector	CR 650E	Stable Drive Future Extension to Haggerty Lane

